

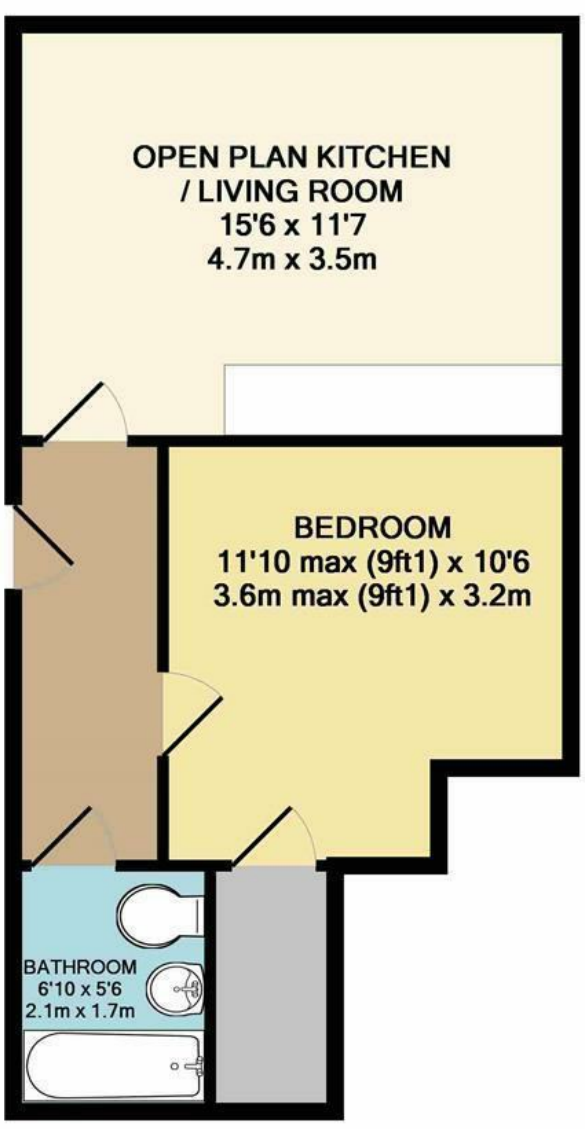

Ber Street | Norwich | NR1
 £145,000



TOTAL APPROX. FLOOR AREA 415 SQ.FT. (38.6 SQ.M.)

Whilst every attempt has been made to ensure the accuracy of the floor plan contained here, measurements of doors, windows, rooms and any other items are approximate and no responsibility is taken for any error, omission, or mis-statement. This plan is for illustrative purposes only and should be used as such by any prospective purchaser. The services, systems and appliances shown have not been tested and no guarantee as to their operability or efficiency can be given
 Made with Metropix ©2017

Energy Efficiency Rating		Current	Potential
Very energy efficient - lower running costs			
(92 plus) A			
(81-91) B			
(69-80) C		67	67
(55-68) D			
(39-54) E			
(21-38) F			
(1-20) G			
Not energy efficient - higher running costs			
England & Wales		EU Directive 2002/91/EC	

Disclaimer – In accordance with the Property Misdescriptions Act, the company gives notice that all descriptions, references to condition, necessary permissions for use and other details are given in good faith and believed to be correct, but any intending lessees do not rely on them as statements of fact, but must satisfy themselves by inspection or other means, as to their accuracy.



abbotFox presents this modern, ground floor apartment, situated within the popular Skipper House development. Located within easy reach of Norwich City centre and a wealth of local amenities, this home represents an ideal opportunity for any first time buyer or buy-to-let investor. Accommodation comprises; entrance hall, open plan living accommodation, double bedroom and stylish bathroom. An internal viewing comes highly recommended.

Situated in the heart of Norwich with transport links via Norwich bus station and train station within close proximity. Skipper House benefits from an enviable position on Ber Street Norwich, sitting in a prominent elevated location overlooking the city.

EPC-D

